

Greentree Commons

PROFESSIONAL & MEDICAL OFFICE

701 to 875 Route 73 North, Marlton, NJ 08053

FOR LEASE

908 – 2,000 RSF



Professional/Medical Office

\$18.00/SF plus Electric

Greentree Executive Commons:

875-C: 1,000 RSF

See attached floor plans

PROPERTY HIGHLIGHTS

- Single story office space with private entrances
- Great location for professional office
- Excellent window lines
- Turn-Key Condition with Great Finishes
- Immediate access to Routes 73 and 70. Only 15 minutes to Center City with easy access to I-295 and NJ Turnpike.
- Amenities in immediate proximity including Whole Foods, WaWa, LA Fitness, Royal Farms, TD Bank, Wells Fargo Bank and numerous restaurants and hotels.

FOR MORE INFORMATION CONTACT:

Rick Schwartz

o 856.988.8880 c 856.669.9115
rick.schwartz@veritasrealestate.net

Annie Schwartz

o 856.988.8880 c 609-605-3675
annie@veritasrealestate.net

701 Route 73 North, Suite 4
Marlton, New Jersey 08053

www.veritasrealestate.net

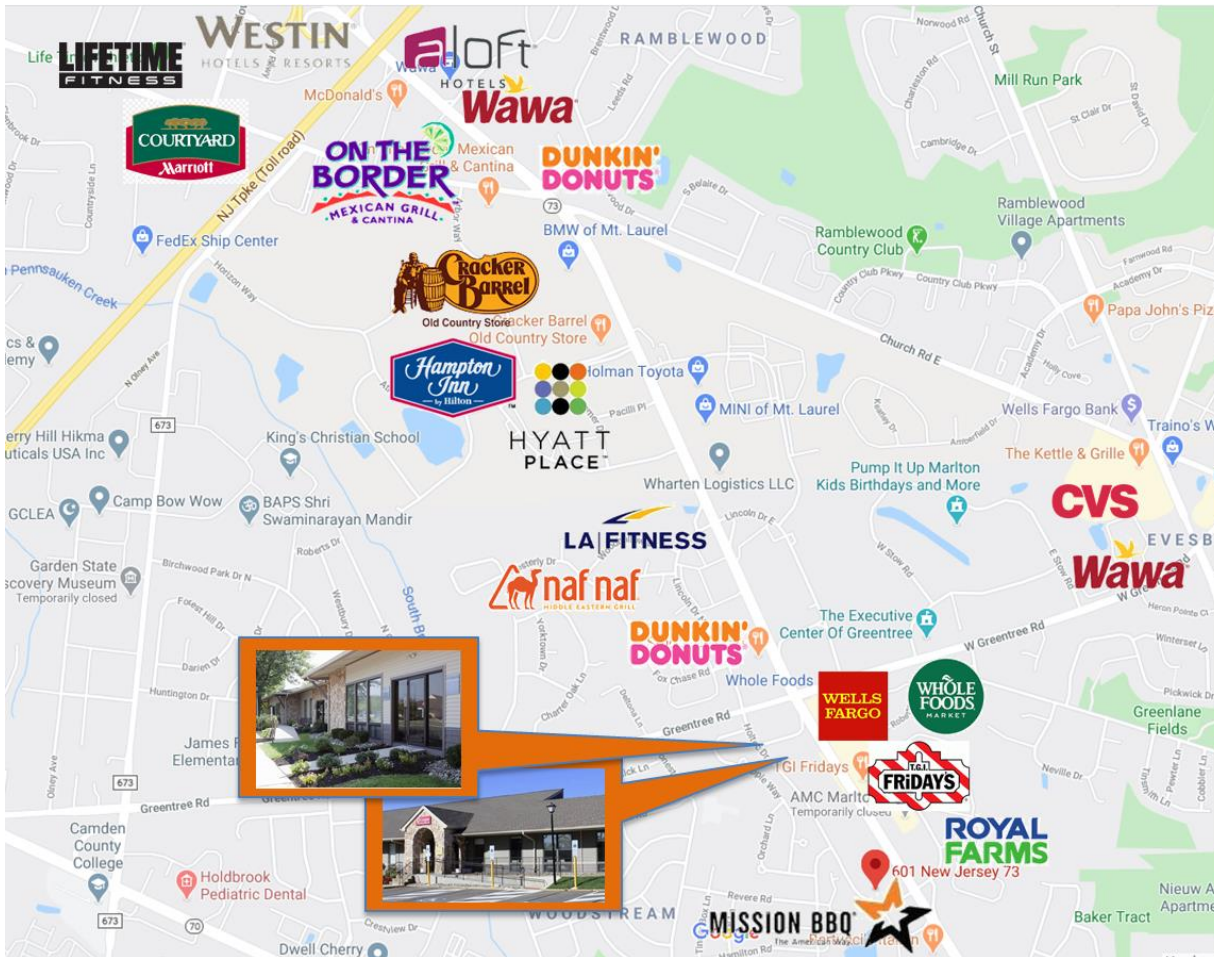

- ✓ 15 minutes to Center City Philadelphia
- ✓ 25 minutes to PHL International Airport
- ✓ 30 minutes to Princeton, NJ
- ✓ 80 minutes to New York City



Rick Schwartz

T: 856-988-8880 | C: 856-669-9115 | F: 856-988-8886
 rick.schwartz@veritasrealestate.net



Annie Schwartz

T: 856-988-8880 | C: 609-605-3675 | F: 856-988-8886
 Annie@veritasrealestate.net



701 Route 73 North, Suite 4
 Marlton, New Jersey 08053
www.veritasrealestate.net

Floor Plan(s) Greentree Commons



Suite 875 C – 1,000 RSF

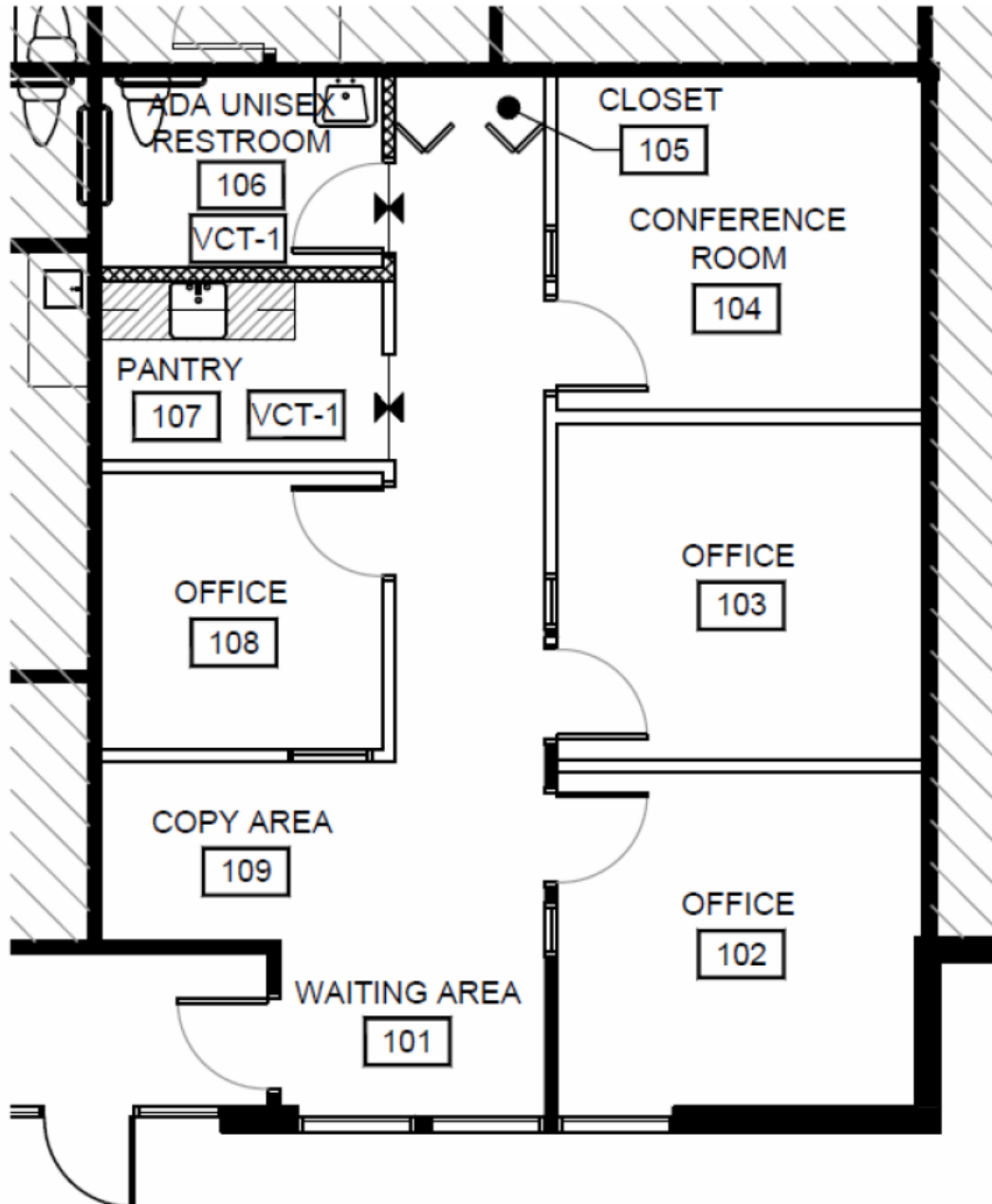

FOR MORE INFORMATION CONTACT:

Rick Schwartz

o 856.988.8880 c 856.669.9115

rick.schwartz@veritasrealestate.net

Annie Schwartz

o 856.988.8880 c 609-605-3675

annie@veritasrealestate.net