

PROFESSIONAL & MEDICAL OFFICE

# Greentree One & Two

9000 & 10000 Lincoln Drive East  
Marlton, NJ 08053

# FOR LEASE

## 6,382 RSF



Professional or Medical  
Office Available

**\$23.00/SF plus Electric**

**Greentree One:**

Fully Leased

**Greentree Two:**

Suite 300                      6,382 RSF  
(can be sub-divided)

## PROPERTY HIGHLIGHTS

- Class 'A' office space
- Great location for professional office
- Excellent window lines
- Turn-Key Condition with Great Finishes
- Immediate access to Routes 73 and 70. Only 15 minutes to Center City with easy access to I-295 and NJ Turnpike.
- Amenities in immediate proximity including Whole Foods, WaWa, LA Fitness, Royal Farms, TD Bank, Citizens Bank and numerous restaurants and hotels.

### FOR MORE INFORMATION CONTACT:

**Rick Schwartz**

o 856.988.8880 c 856.669.9115  
[rick.schwartz@veritasrealestate.net](mailto:rick.schwartz@veritasrealestate.net)

**Annie Schwartz**

o 856.988.8880 c 609-605-3675  
[annie@veritasrealestate.net](mailto:annie@veritasrealestate.net)



701 Route 73 North, Suite 4  
Marlton, New Jersey 08053

[www.veritasrealestate.net](http://www.veritasrealestate.net)

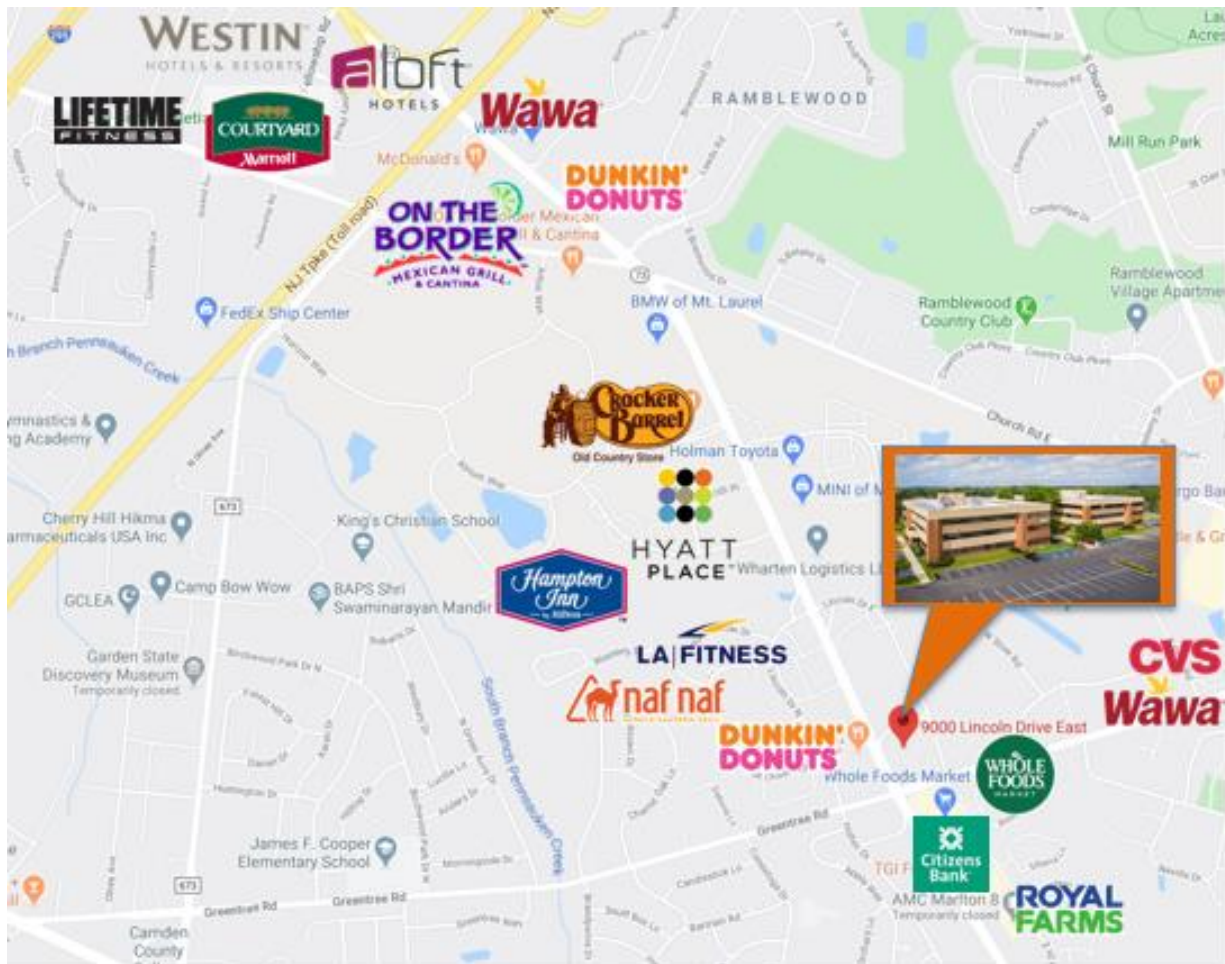

- ✓ 15 minutes to Center City Philadelphia
- ✓ 25 minutes to PHL International Airport
- ✓ 30 minutes to Princeton, NJ
- ✓ 80 minutes to New York City



**Rick Schwartz**

T: 856-988-8880 | C: 856-669-9115 | F: 856-988-8886  
 rick.schwartz@veritasrealestate.net



**Annie Schwartz**

T: 856-988-8880 | C: 609-605-3675 | F: 856-988-8886  
 Annie@veritasrealestate.net



701 Route 73 North, Suite 4  
 Marlton, New Jersey 08053  
[www.veritasrealestate.net](http://www.veritasrealestate.net)

# Floor Plan(s) Greentree One & Two



## Greentree Two Suite 300 – 6,382 RSF (can be sub-divided)

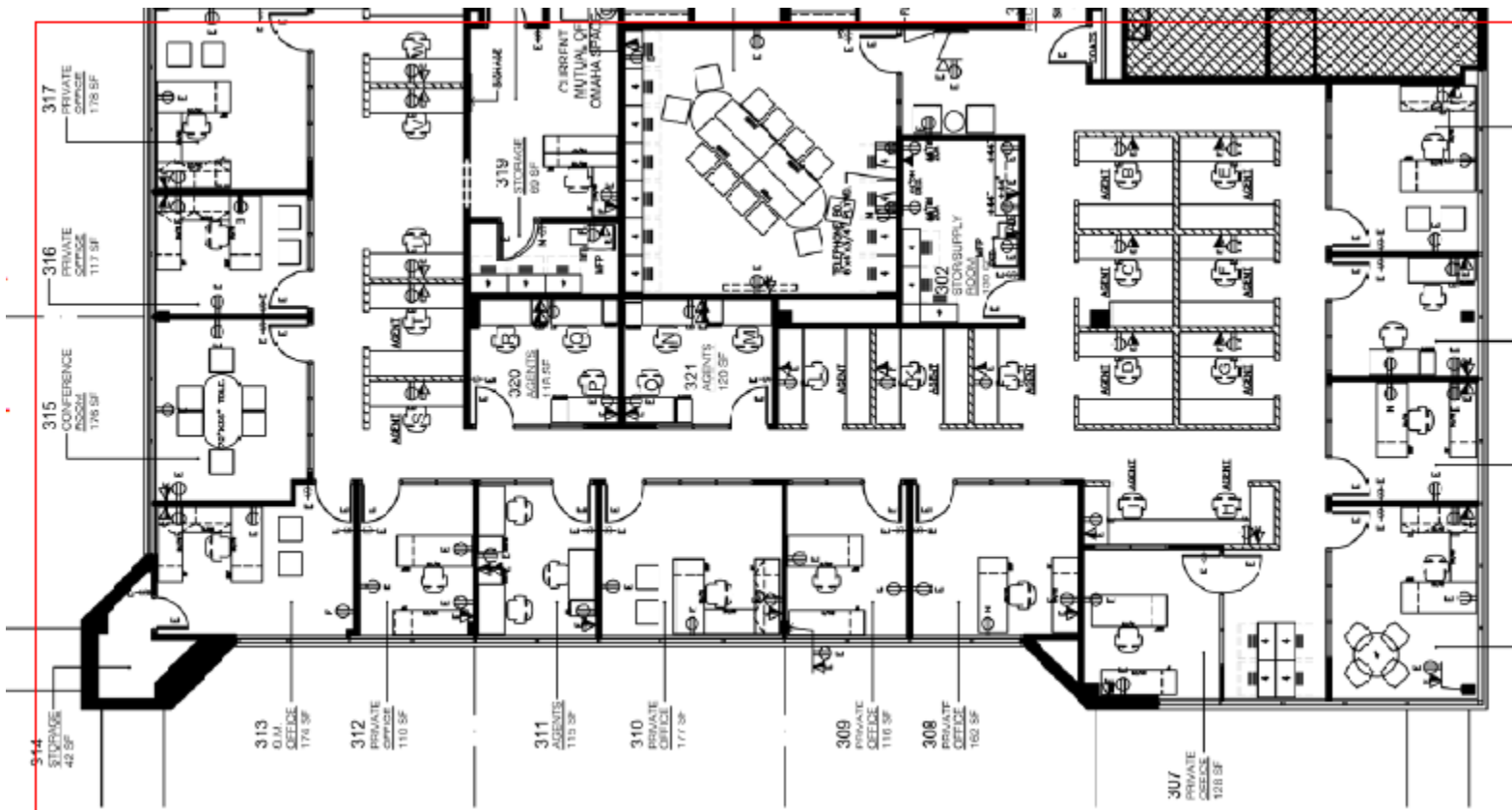

**FOR MORE INFORMATION CONTACT:**

**Rick Schwartz**

o 856.988.8880 c 856.669.9115  
[rick.schwartz@veritasrealestate.net](mailto:rick.schwartz@veritasrealestate.net)

**Annie Schwartz**

o 856.988.8880 c 609-605-3675  
[annie@veritasrealestate.net](mailto:annie@veritasrealestate.net)